

Features

1. PRI-RGBD-XX is especially design for our PRI-POOL-RGB-RE, PRI-POOL-RGB-X&XL. PRI-RGB-XC, PRI-POOL-RGB-XP and PRI-POOL-RGB-30W
2. PRI-RGBD-XX is designed for waterproof; it can be used for both indoor and outdoor.
3. PRI-RGBD-XX-200W can control 10PCS 18W LED lights & 5PCS 30W LED lights.

Specifications

Item Code:	PRI-RGBD-XX	Quiescent current:	<6mA
Input Voltage:	240VAC	RF Sensitivity (dBm):	-101
Output Voltage:	12VAC	Work Temperature:	-40°~ +70°C
Input current:	0.5A~10A (According to the total LED light you use)	Work humidity:	10% ~ 90% RH
Dynamic current:	According to your loads (standard: 500mA)	Control Distance:	100 M
		Dimension:	160 X 160 X 90 mm
		Weight:	1.8 Kg

Instruction of set remote controller code

Set code of remote controller:

1. There are two hand remotes inside PRI-RGBD-XX.
2. Press the white button for a short time (no more than 2 seconds). The red LED is on when the button is pressed.
3. Press a button of the hand remote (A or B). The red LED is on when a button is pressed.

After setting code of remote controller, PRI-RGBD-XX can be controlled by hand remote.

If you want to clear all the connections between the hand remotes (may be more than 3 remotes..) and the controller, press the white button in the box for over 5 seconds (when you press it, the red LED is on, press it till the LED is off).

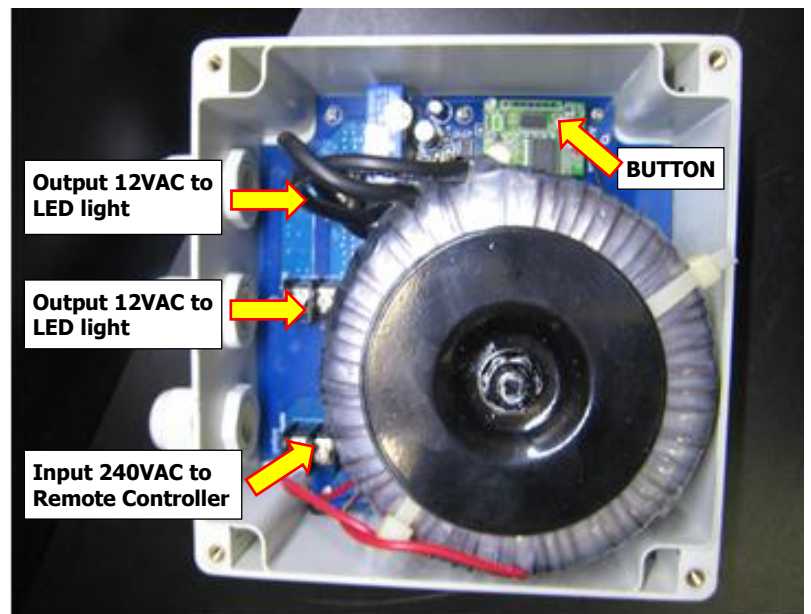

Inner structure of the PRI-RGBD-XX

hand remote

